

6500 Series

Rotary Phase Converters Mechanical Dimensions



TEMCo Heavy Duty Rotary Phase Converters provide utility quality three phase power from a single phase power supply. TEMCo's world class products are being used throughout the United States and internationally.

Phase Converter Features:

6yr Full 6 Year Warranty

HEAVY DUTY Rugged Heavy Duty Rotary Design

100% Copper Windings
(Energy Efficient, Environmentally Friendly)

100% American Made

208-240v or 440-480v Operation

Quiet Operation, 63db @ 10ft
(No Louder Than Human Conversation)

Phase Converter Drawing:

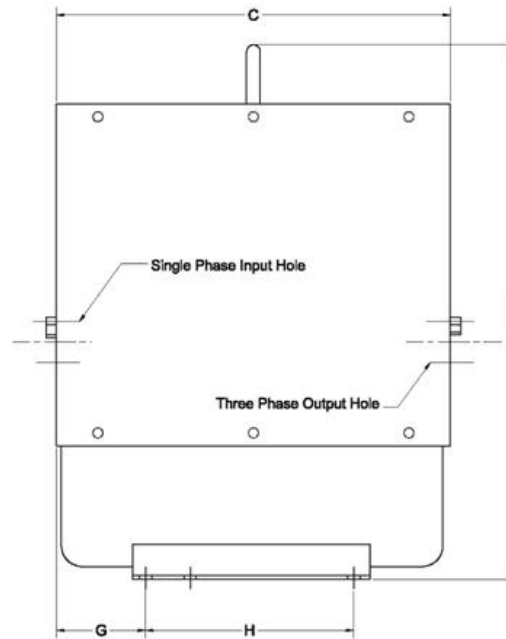
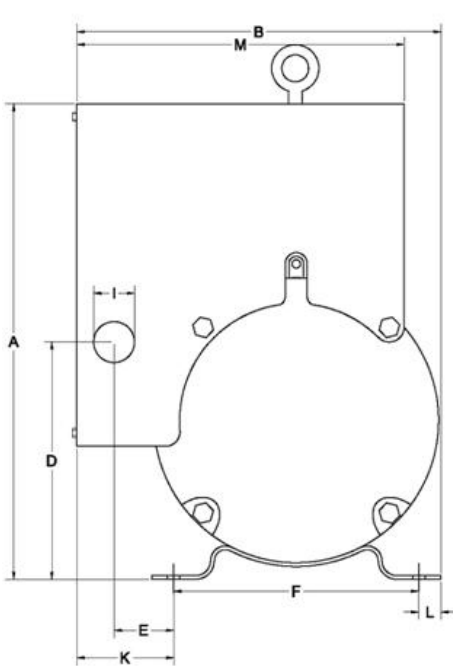

Dimensions (Approx, Inches):

Model	A	B	C	D	E	F	G	H	I	J	K	L	M	Approx. Weight
2	14.25	11.00	12.00	7.75	2.87	7.50	4.25	5.50	1	15.75	4.12	0.50	10.00	80
3	15.75	12.25	12.62	7.75	1.87	8.50	2.50	7.00	1-3/8	17.50	3.25	0.50	11.12	120
5	15.75	12.25	12.62	7.75	1.87	8.50	2.50	7.00	1-3/8	17.50	3.25	0.50	11.12	120
7.5	15.75	12.25	12.62	7.75	1.87	8.50	2.50	7.00	1-3/8	17.50	3.25	0.50	11.12	135
11	19.75	15.00	16.15	9.25	2.87	10.0	2.75	10.0	1-3/4	21.75	3.31	0.63	13.65	205
15	19.75	15.00	16.15	9.25	2.87	10.0	2.75	10.0	1-3/4	21.75	3.31	0.63	13.65	240